



# Strathcona County Indoor Soccer Centre



PRESENTATION OCTOBER 23, 2018

SHERWOOD PARK DISTRICT SOCCER ASSOCIATION

# SPDSA History & Mission Statement

The Sherwood Park District Soccer Association is non-profit society, established in 1976, that serves to promote and encourage the game of soccer in Sherwood Park.

*The Sherwood Park District Soccer Association is committed to providing its members the opportunity to participate in recreational and competitive soccer leagues by teaching and demonstrating soccer skills, sportsmanship, honesty, respect, and fair play. The SPDSA promotes the game of soccer in a safe environment where our members can not only excel in their soccer skills but may also learn the importance of physical fitness in their lives.*

# SPDSA Soccer Seasons - Current

- Outdoor soccer season; May to June or July, 2 or 3 months
- \*some teams advancing to Provincials / Nationals play longer, including our U17 Girls who just placed 5<sup>th</sup> place in Canada. And our Mens Masters team who won the Western Canada Championship recently.
- Indoor soccer season; October to March, 6 months
- 2100 indoor soccer participants registered with the SPDSA
- Community Teams playing against other teams within Sherwood Park
- Competitive Program – Sherwood Park Phoenix
- Mens and Ladies including Masters, Co-Ed Program, playing in either EIYSA or EMSA leagues based out of Edmonton

# SPDSA Current Facilities

- The SPDSA employs over 15 Administration and Technical Staff housed at Kaska Road offices.
- County facilities for indoor soccer include two fields at Millennium place.
- 17 school gymnasiums used for practices.
- The SPDSA cannot offer indoor soccer to all the youth in the County who have a desire to participate. We turn away potential new players each year due to a lack of facilities.
- Our teams are spending additional funds to play at various other city facilities such as Foote Field, Victoria, Turf Training Centre, Fort Saskatchewan and other indoor soccer facilities. We have acquired information on this to be in excess of \$30,000 last season.

# Our Proposal – Short Term

The SPDSA proposes the development of a full size non-boarded indoor recreation facility. This will be an air-supported dome with turf field and a running and walking track.

Including;

- Facility Clubhouse of 7400 sq ft; with lobby, washrooms, concession and change rooms.
- Potential New SPDSA Offices of 5000 sq ft; (funded by SPDSA)
- Some of you are familiar with Foote Field, Scottish Soccer Dome, and many in Ontario and other cities

# Air Supported Indoor Soccer



Total Area  
96,596ft<sup>2</sup>

Dome Area = 89,169ft<sup>2</sup>

Amenities include:

- Full-sized non-boarded field
- Warm up area
- Spectator seating

Clubhouse Area = 7,427ft<sup>2</sup>

Amenities include:

- Change rooms
- Bathrooms
- Concession
- Office space
- Reception
- Lobby



# Our Proposal



\*Photos courtesy of social media

# Our Proposal

Based on some preliminary project estimates.

Total Capital Cost  
**\$5.5M**  
(excluding land)

Annual Operating Budget  
**\$872K (seasonal dome)**

Annual operating expenses will be recovered through program fees, rentals and other revenue.

Foote / Scottish





# Direct Benefits of Soccer - 'Full Size Non-Boarded'

- Provides for long term athlete development of the traditional game.
- Reduce injuries caused by the indoor boarded facilities and gymnasiums.
- Additional program capacity to include all interested families, from youth to adult.
- SPDSA has been part of the Community and Culture of Strathcona County for more than 40 years – this facility will be the home of programming.
- Keeps pace with other communities and clubs advancing their programs.
- Put Sherwood Park in the conversation for World Cup 2026

# Other community benefits

- Foster growth in other healthy and vibrant activities and sports for youth, adults and seniors including; baseball, lacrosse, football, rugby, frisbee, running and walking, school groups during the day.
- Free up much needed school gymnasium time at the 17 schools for court sports such as volleyball, basketball, badminton and floor hockey. 1100 hours will be available for other groups.
- The dome will be a major sporting facility attracting events from outside the County and Province. Hosting events will showcase the County and support local restaurants, hotels and many other local business.

# Additional Capacity

- Regional collaboration. Depending on the size of the Dome, amenities added and the chosen location the Soccer dome could be made available to other soccer teams / leagues and users groups from surrounding regional municipalities.
- Daytime capacity potential from senior groups, or school programs requiring field space for various activities.

# Locations

Potential County facility location (5 to 10 acre site);

- Millenium soccer fields, SPDSA preference.
- Fultonvale school, preliminary partnering discussions have been held with EIPS
- Combined with another sports development
- Other 5 to 10 acre property in Strathcona County



# Our Long Term Plan

## Permanent Facility to be included in a future development

### Main Program Elements

#### Option #2

Total Area  
200,017ft<sup>2</sup>

Amenities include:

- Full-sized non-boarded field
- Three lane running track
- Warm up area
- Offices
- Meeting room
- Partner space
- 16 locker rooms
- Team fitness space
- Additional partner space
- Restaurant and lounge
- Multi-purpose room
- Lease space
- Court space

### Costs

Total Capital Cost

**\$51.5M**

(excluding land)

Annual Operating  
Budget

**\$2.0M**

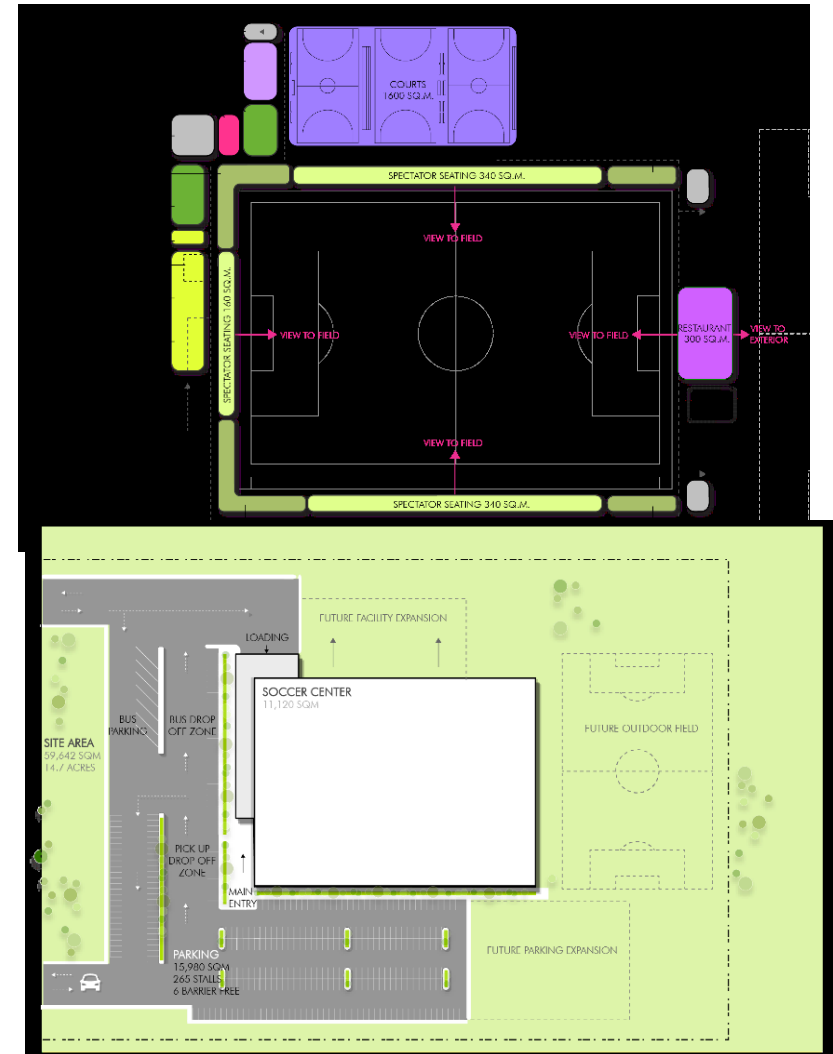

# SPDSA Facility Development

- We are asking for the planning and development of an air supported indoor soccer facility be included in the County budget for the next fiscal year.
- To have a dome facility ready for the 2020 indoor soccer season (fall 2020), planning would take place during the winter of 2018/2019 with construction underway by May 2019.
- Based on recently built locations in Edmonton and with experienced contractors nearby we believe this to be achievable and valuable for the County to pursue.



# Questions?



# Thank You

Dave Friesen; D.Friesen@spdsa.net

Darrell Bradley; D.Bradley@spdsa.net

Ian Johnston; I.Johnston@spdsa.net

