

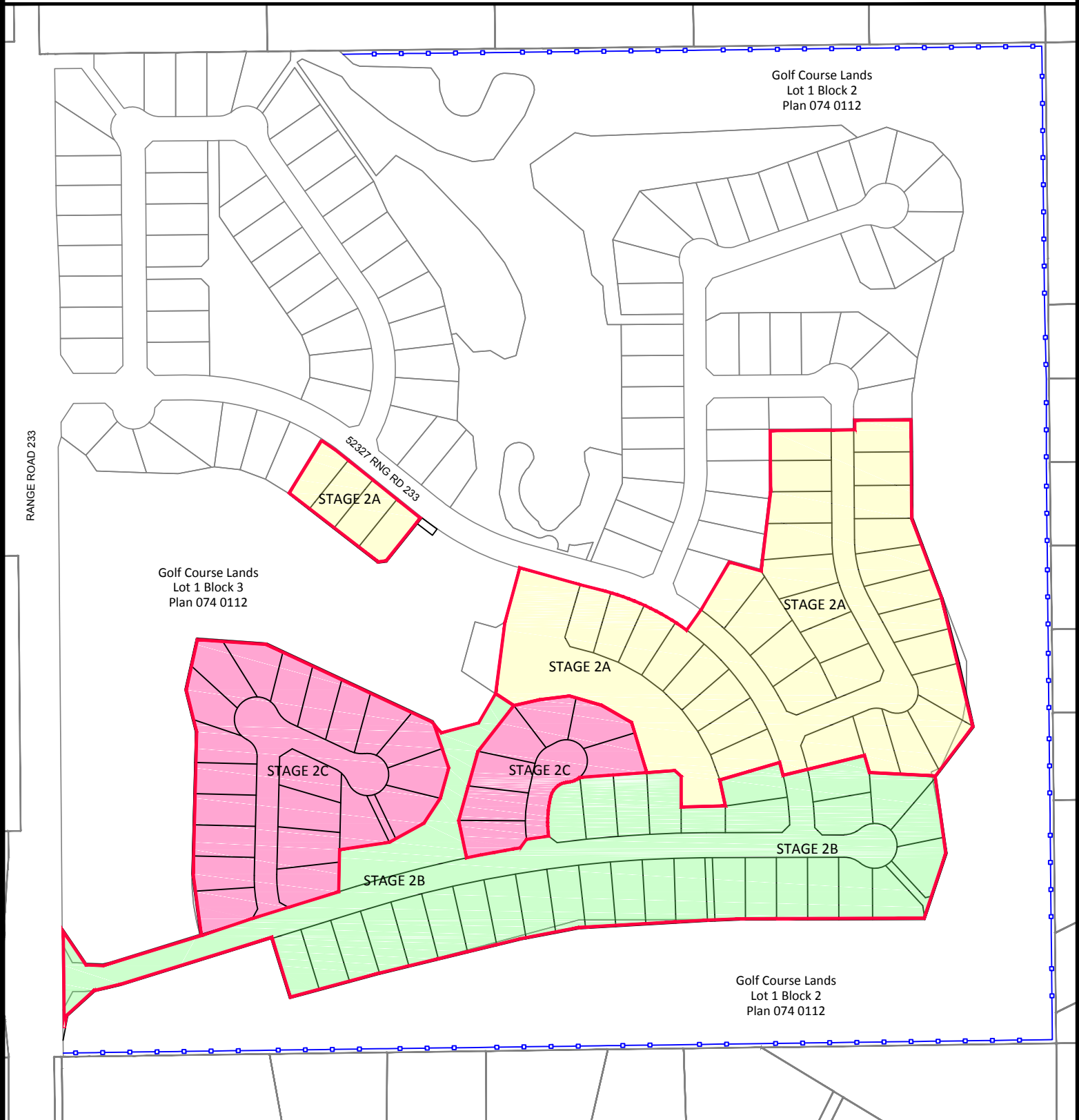

SCHEDULE "B" Page 1 of 2 Overall Development Area

ENCLOSURE 1



**SHERWOOD GOLF ESTATES STAGE 2
LOT 1 & 2 BLOCK 4 PLAN 0740112
SW 22-52-23-W4**

 Development Boundary
Development Area = 17.59 ha (43.46 ac) ±

 Fencing

Drawn By: J. Cavers

Date Drawn: Aug 19, 2015

Scale: Not to Scale

File No.: 4050-2014S030

Revision Date: April 18, 2016

Revision No.

Dwg. No.:

PLANNING & DEVELOPMENT SERVICES

 STRATHCONA
COUNTY

